

INSTALLATION, APPLICATION AND MAINTENANCE HANDBOOK FOR REVER SINGLE LEAF DOORS

156-GB

5001016/2 - 06/13

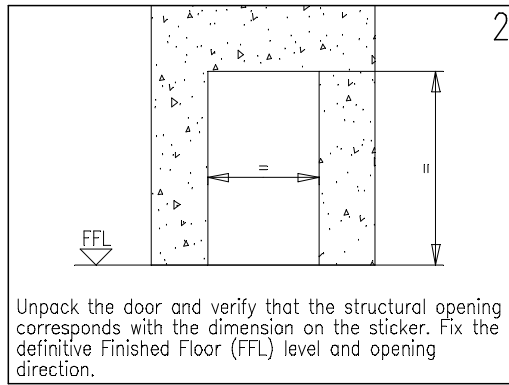
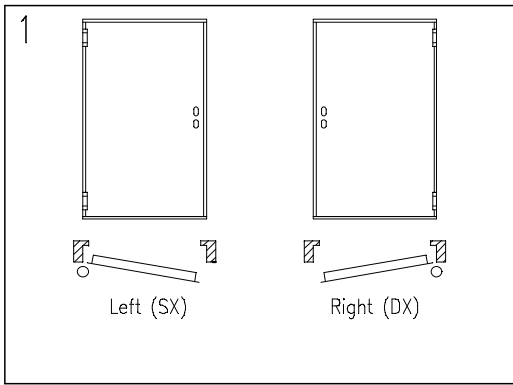

Unpack the door and verify that the structural opening corresponds with the dimension on the sticker. Fix the definitive Finished Floor (FFL) level and opening direction.

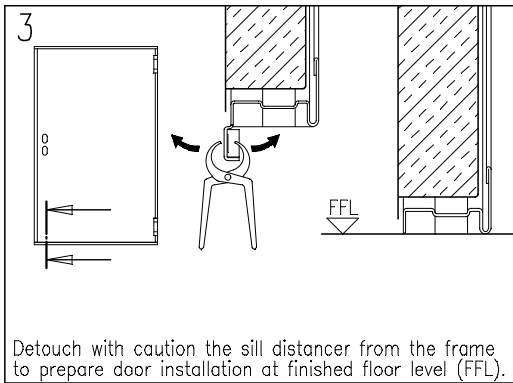

Detach with caution the sill distancer from the frame to prepare door installation at finished floor level (FFL).

WITH BRACKETS

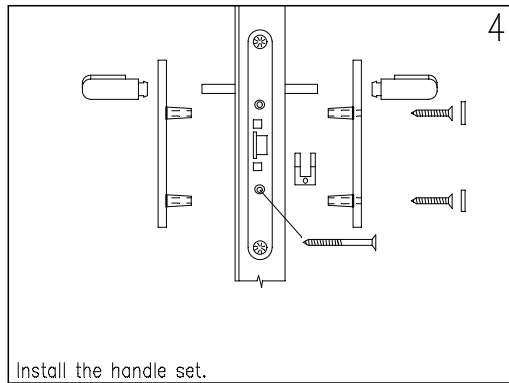

Install the handle set.

WITH EXPANSION SCREWS

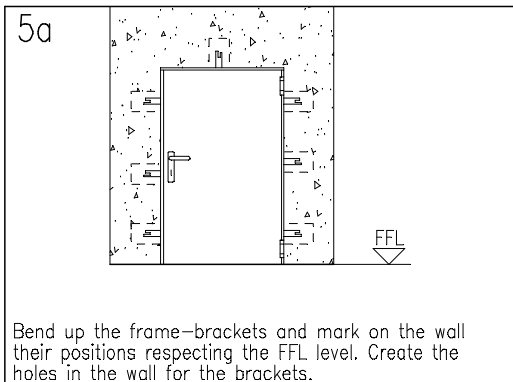

Bend up the frame-brackets and mark on the wall their positions respecting the FFL level. Create the holes in the wall for the brackets.

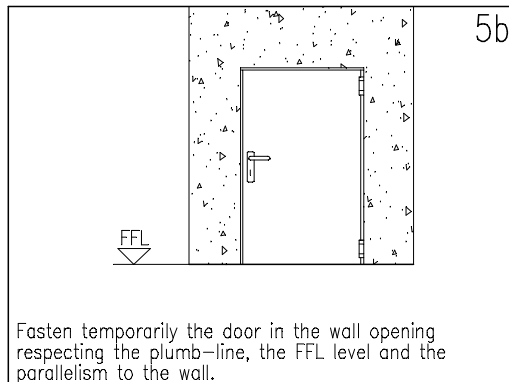

Fasten temporarily the door in the wall opening respecting the plumb-line, the FFL level and the parallelism to the wall.

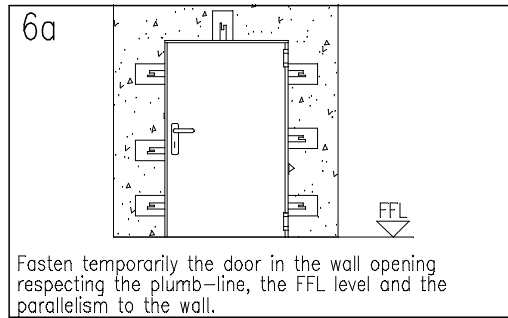

Fasten temporarily the door in the wall opening respecting the plumb-line, the FFL level and the parallelism to the wall.

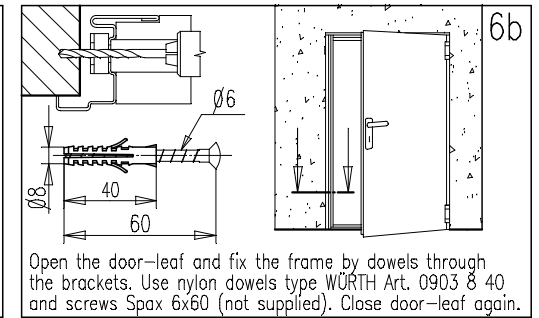

Open the door-leaf and fix the frame by dowels through the brackets. Use nylon dowels type WÜRTH Art. 0903 8 40 and screws Spax 6x60 (not supplied). Close door-leaf again.

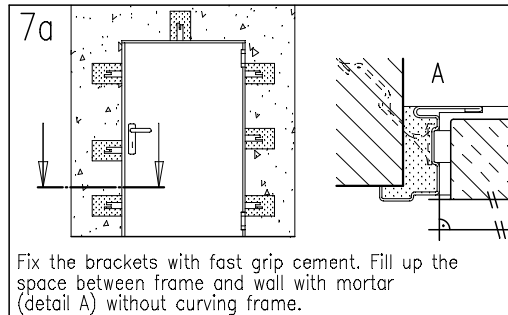

Fix the brackets with fast grip cement. Fill up the space between frame and wall with mortar (detail A) without curving frame.

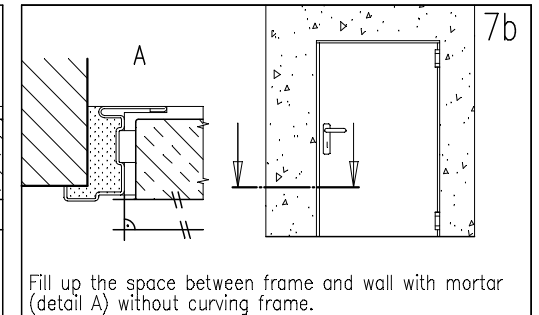

Fill up the space between frame and wall with mortar (detail A) without curving frame.

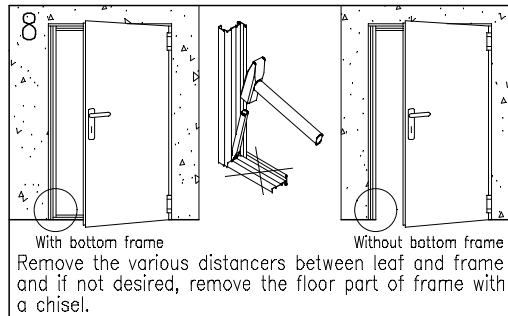

Remove the various distancers between leaf and frame and if not desired, remove the floor part of frame with a chisel.

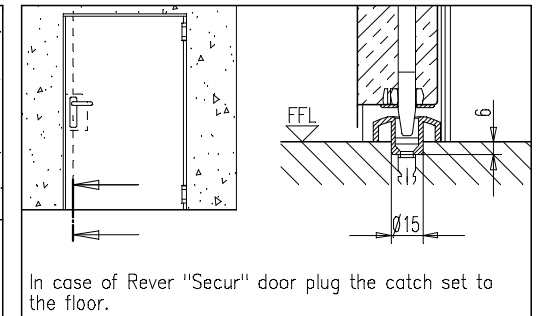

In case of Rever "Secur" door plug the catch set to the floor.

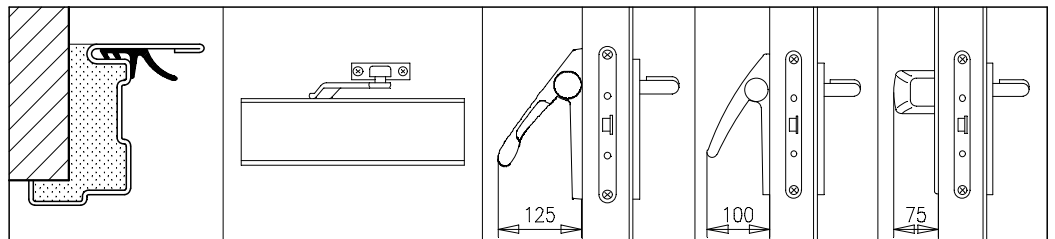

Optionals: rebate sealing - overhead doorcloser - antipanic bar EXUS, TWIST or SLASH.

INSTALLATION, APPLICATION AND MAINTENANCE HANDBOOK FOR REVER SINGLE LEAF DOORS

156-GB

GENERAL NOTES

LIABILITY: It is duty of the installer to follow the installation instructions in any detail.

FINISHINGS: the serial Rever color-door is finished with an epoxy-polyester powder paint oven-baked at 180° C. The surface is goffered and particulary resistant. In case an additional paint is desired we advise to follow these instructions:

- make smooth the surfaces with sandpaper and dust them
- give a first hand of opaque 2 components epoxide using the product ALCEA EPOX 5203 / 0059 (beige)
- finish the surfaces with enamels or paints to your choice.

CLEANING: the doors are supplied from the factory clean and packed. We suggest to use a clothe and soaped water only. Do not scratch the surfaces.

WARRANTY: the manufacturer gives warranty as per Italian law (C.C.1495). Any claim for missing or damaged goods have to be recorded by inserting a written remark in the delivery notes and must be notified the maximum within eight days from the date of materials receipt.

MAINTENANCE INSTRUCTIONS FOR REVER DOORSETS

All doors must be controlled to verify that there are no damages and that they close well. Controls must be done periodically to assure that door-leaf turns freely, that closing and opening devices are efficient and that doors close perfectly. Doors must be kept free from obstructions.

Any 5.000 opening cycles but at least every 6 months the following operations shall be carried out:

- Lubricate hinges
- Lubricating the lock and the latch

For doors with three closing points more checks have to be done:
Verify the regular working of the closing rods and lubricate their sliding paths
Eliminate any dirt from the hole of the floor catch

Verify the regular functionality of the doorset's accessories (handle, antipanic bar, overhead doorcloser etc.). Their mobile parts shall be lubricated too, following the dedicated instructions.

In case of irregular functioning of the doorset or its accessories contact an authorized installer or replace the damaged accessories.

Note: for lubrication use viscous products.

HANDLING AND STORAGE — COMPLAINTS

Handling: in case of handling with webbing slings/ropes, place them under the feet of the pallet; avoid to place them under the boards; avoid that the action of slings/ropes produces too much pressure upon the doors, by means of spacers interposed in the upper part. Do not handle the leaves using suction caps.

Storage: it is duty of the company/person taking over the doors to store them in a suitable place so that they will be protected from the natural agents and from the direct sun rays. If during transportation or truck unloading it rains or snows on the doors it is necessary to remove immediately the nylon film from each leaf and doorframe, put them in vertical position to dry appropriately.

Complaints: in case of external visible defects on doors, they have to be marked in the copy of the transportation document to be returned to the forwarder and notified to the manufacturer by registered mail within 48 hours. We remember that according to our general conditions intrinsic defects have to be notified to the manufacturer within 8 days from the delivery date by registered mail. Goods with defects never have be utilised or assembled, they should be stored at disposal for controls by the manufacturer appointed person.

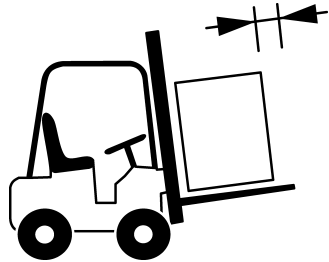

Move the materials with appropriate means.

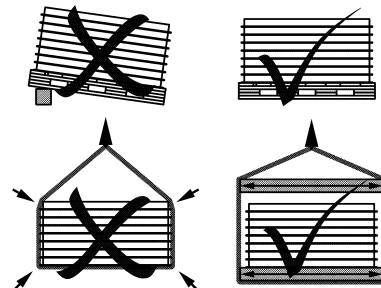

Store and handle the materials with care.

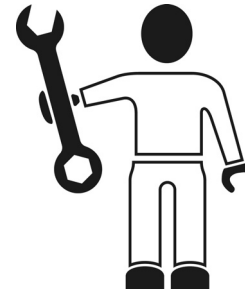

Assemble by qualified staff only.



Do not expose the materials to the natural agents.